

ANOKA COUNTY ROAD 14

A NEW ROAD, A NEW WAY

PROJECT OVERVIEW

This project will reconstruct three miles of Anoka County Road 14 from east of Crane Street in Coon Rapids to west of Ulysses Street in Blaine. The reconstructed roadway will be a four-lane divided urban highway with turn lanes and traffic signals.



CONSTRUCTION SCHEDULE

Construction is scheduled to begin in late June 2011 and will continue through August 2, 2012. Official detour routes will be provided for all road closures.

Construction Activity	Start Date*	End Date*	Notes
2011			
• FULL CLOSURE: County Road 14 closed between University Avenue and Jefferson Street	July 2011	September 2011	North/South traffic will continue single lane on Jefferson and University
• South half of County Road 14 rebuilt between Jefferson Street and Ulysses Street	July 2011	November 2011	Single lane traffic in each direction will continue on north portion of County Road 14
• FULL CLOSURE: County Road 14 closed between Avocet Street and Olive Street	September 2011	August 2012	Closure needed to build overpass at railroad crossing
• SHORT-TERM FULL CLOSURES: County Road 14 closed between Crane Street and Avocet Street	TBD	TBD	No more than 21 days total in 2011
2012			
• North half of County Road 14 rebuilt between Jefferson Street and Ulysses Street	Spring 2012	August 2012	Single lane traffic in each direction will continue on new southern section completed fall 2011
• FULL CLOSURE: County Road 14 closed between Avocet Street and University Avenue	Spring 2012	August 2012	North/South routes will remain open at Foley, Flintwood and University
• SHORT-TERM FULL CLOSURES: County Road 14 closed between Crane Street and Avocet Street	TBD	TBD	No more than 21 days total in 2012

*All dates are approximate, weather permitting and subject to change.

STAY INFORMED

For more information and construction updates on the Anoka County Road 14 project:

Project Information Line: 1-877-254-3997

Website: www.anokacounty.us/countyroad14 • Email: countyroad14@co.anoka.mn.us



@AnokaCountyHwy



Search "Anoka County Road 14"

DATES SHOWN ARE ANTICIPATED DATES AND ARE SUBJECT TO CHANGE.

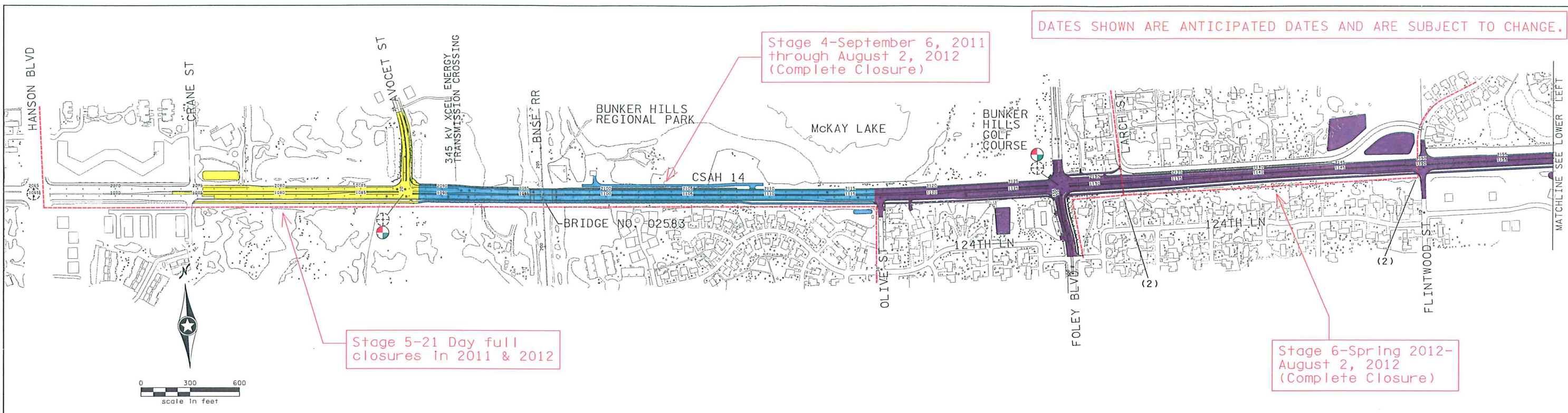

Stage 4-September 6, 2011 through August 2, 2012 (Complete Closure)

Stage 5-21 Day full closures in 2011 & 2012

Stage 6-Spring 2012-August 2, 2012 (Complete Closure)

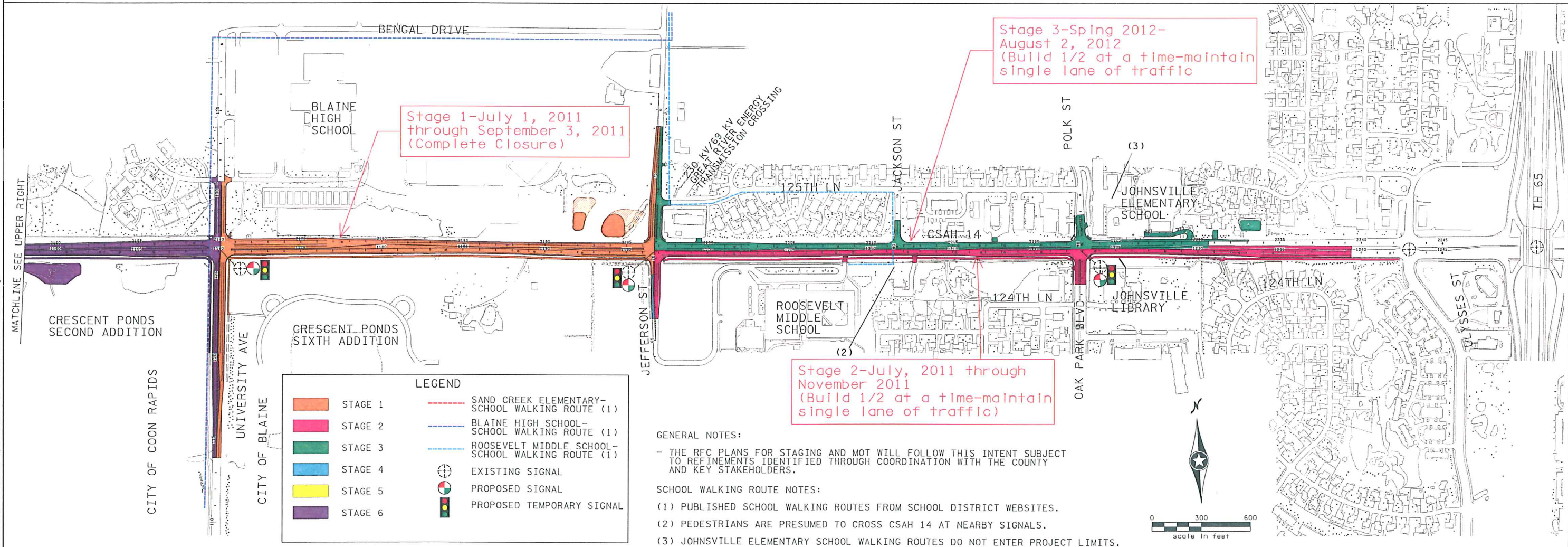

Stage 1-July 1, 2011 through September 3, 2011 (Complete Closure)

Stage 3-Spring 2012-August 2, 2012 (Build 1/2 at a time-maintain single lane of traffic)

Stage 2-July, 2011 through November 2011 (Build 1/2 at a time-maintain single lane of traffic)

LEGEND

	STAGE 1		SAND CREEK ELEMENTARY-SCHOOL WALKING ROUTE (1)
	STAGE 2		BLAINE HIGH SCHOOL-SCHOOL WALKING ROUTE (1)
	STAGE 3		ROOSEVELT MIDDLE SCHOOL-SCHOOL WALKING ROUTE (1)
	STAGE 4		EXISTING SIGNAL
	STAGE 6		PROPOSED SIGNAL
			PROPOSED TEMPORARY SIGNAL

GENERAL NOTES:
 - THE RFC PLANS FOR STAGING AND MOT WILL FOLLOW THIS INTENT SUBJECT TO REFINEMENTS IDENTIFIED THROUGH COORDINATION WITH THE COUNTY AND KEY STAKEHOLDERS.

SCHOOL WALKING ROUTE NOTES:
 (1) PUBLISHED SCHOOL WALKING ROUTES FROM SCHOOL DISTRICT WEBSITES.
 (2) PEDESTRIANS ARE PRESUMED TO CROSS CSAH 14 AT NEARBY SIGNALS.
 (3) JOHNSTVILLE ELEMENTARY SCHOOL WALKING ROUTES DO NOT ENTER PROJECT LIMITS.

9:01:23 AM
 6/21/2011
 H:\Projects\7461\NH-MUA\Graph\csah14\0621_Open House No.1\7461_STAGING OVERVIEW.dgn

NO	DATE	BY	CKD	APPR

...7461_STAGING OVERVIEW.dgn



C.S. McCrossan



CSAH 14 DESIGN BUILD (SAP 002-614-034)		SHEET
STAGING OVERVIEW		1
C.S.A.H. 14		OF
PUBLIC OPEN HOUSE JUNE 21, 2011		1