



Swimming Pools, Hot Tubs, Ponds, & Spas

What do I need to submit to obtain a permit?

A site plan is required with two sets of plans drawn to scale, with specifications on structural design, operation, and maintenance. The plans must include the following:

1. A layout of the site (site plan) with the location, length, depth and width of the pool, spa, or hot tub and any decking and distance of the pool, spa/hot tub to lot lines. (See example)
2. On site plan, show all existing building on the lot and distance to lot lines.
3. Detailed drawing of fence design, gate design and latching mechanisms.
4. All above and below ground utilities on the lot (including gas, electric, sewer, water, phone, etc.)
5. A copy manufacturer's specifications on operation and maintenance.
6. Source and location of water supply.
7. Installing temporary or inflatable pools greater in 24" in depth and more than 5,000 gallons. A fence will be required and will need to follow the regulations stated in the fence section.

What type of permits do I need?

1. A building permit is required for in-ground and above ground pools, ponds, hot tubs, and spas.
2. A mechanical permit is required for installation of a heater for any pools, ponds, hot tubs, or spas.
3. An electrical permit is required for all pools, ponds, hot tubs, spas. An electrical permit is obtained through the City of Coon Rapids.

What type of inspection is required?

1. A site inspection is required after location of pool or pond is determined but before pool or pond is in place. Lot irons must be visible at time of site inspection.
2. Footings for pools, decks, and fences.
3. Concrete forms, gas line air test for pool heater, heating and plumbing. Electrical inspection on all new or associated electrical work.
4. Final inspection for code compliance upon completion.

*If at any time changes or alterations are made to from the approved stamped plans, a supplementary plan covering the work involved shall be submitted for approval and must conform to all requirements.

Do I need to install a fence/barrier in my yard?

Note that requirements for fences/barriers associated with pools, spas, and hot tubs are more specific than simply installing a four (4) foot fence.

A successful pool barrier prevents a child from getting OVER, UNDER, or THROUGH and keeps the child from gaining access to the pool except when supervising adults are present.

- All pools, swimming pools, spas, and hot tubs with a **depth of 24" or greater** must be surrounded by a **non-climbable** barrier or fence with a **self – closing and self – latching gate**.

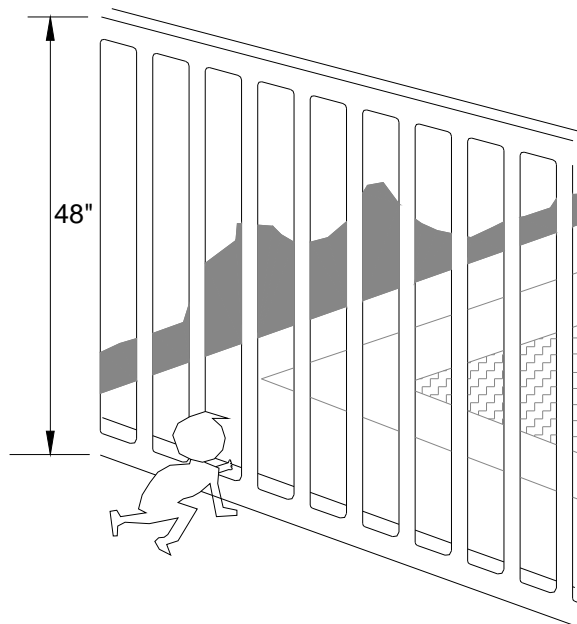

- **Barriers, fences and gates must be at least four (4) feet high.**

In-ground pools: the barrier must be at least four (4) feet from the waterline.

Above ground pools, spas, or hot tubs: with sides or attached fences which reach four (4) feet in height, do not require an additional fence. Where the above ground pool structure is used as the barrier, the access ladder or steps shall be capable of being secured, locked, removed, or otherwise protected to prevent access.

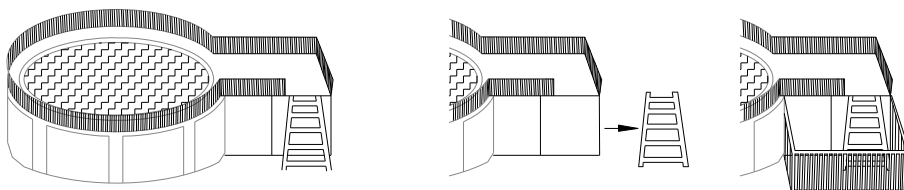

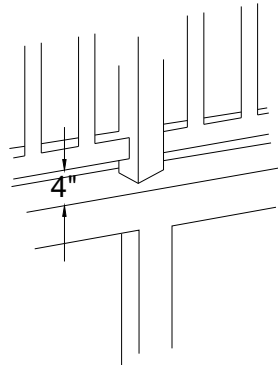

If an above ground pool had a barrier on the top of the pool, the maximum vertical clearance between the top of the pool and the bottom of the barrier shall not exceed four (4) inches.

- The distance between the bottom of the fence (or barrier) and grade beneath it shall not exceed 2" (two inches).
- Openings in the barrier (i.e.: spaces between fence pickets, railing balusters, etc.) shall not allow passage of a four (4) inch sphere.

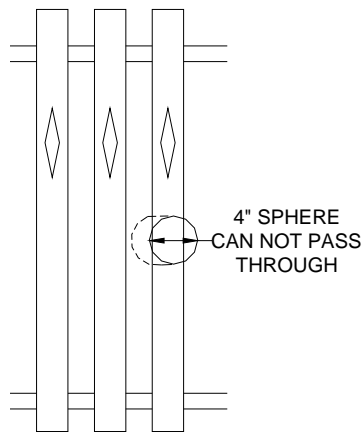

• Spacing of vertical members of fence depends upon the spacing of the horizontal members. Where spacing from the top of the bottom horizontal member to the top of the next horizontal member is less than forty five (45) inches, spacing of vertical members shall not exceed one and three quarters (1.75) inches.

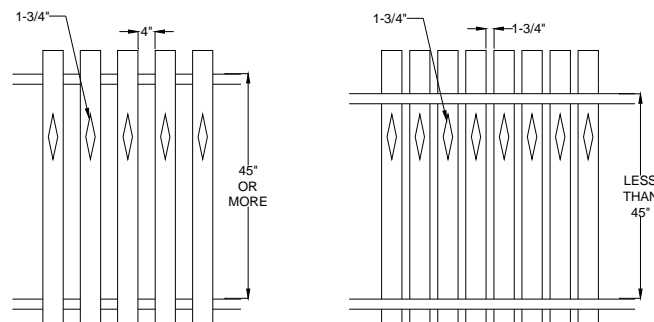

For **chain link** fences or **lattice work fences**, the following pictures apply:

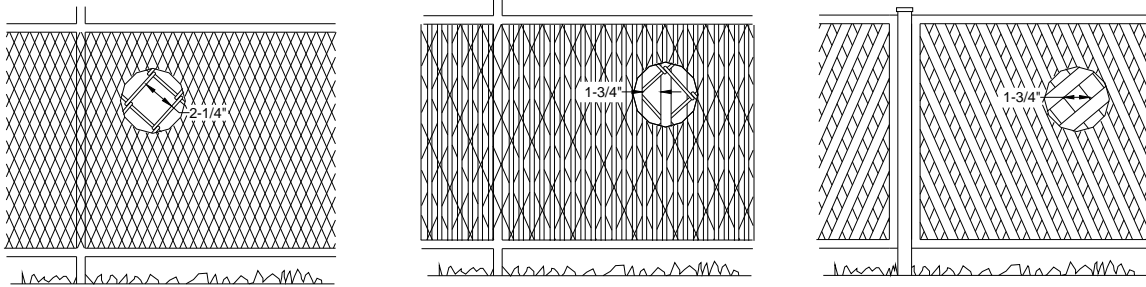

- **Gates** shall open outward away from the pool, shall be **self-closing**, and shall have a **self-latching device**.

Where the release mechanism of the latching device is located less than fifty four (54) inches from the bottom of the gate, the release mechanism shall be located on the pool side of the gate at least three (3) inches below the top of the gate, and the gate and barrier shall have no opening greater than one half (1/2) inch within eighteen (18) inches of the release mechanism.

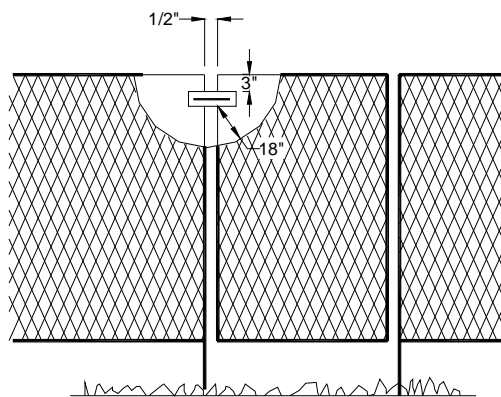

- **Doors** with direct access to the pool shall also be self-latching, secured, protected, or alarmed, or the pool shall have a power safety cover.

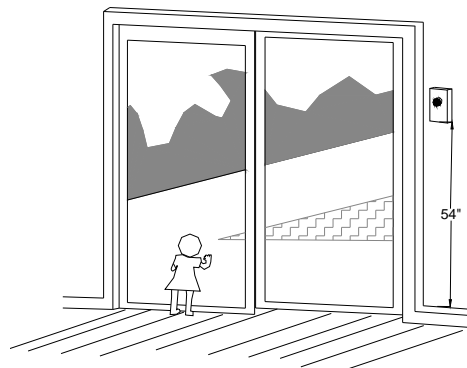

What items will be inspected?

Fences and Barriers – Designed to keep a child from gaining access to the pool unless supervised by an adult.

Structural Design – the structure shall be engineered and designed to withstand the expected forces to which it will be subjected.

Overflow and Surface Drainage – designed so no splash or overflow water, surface or roof drainage will return or enter the pool

Finish – the sides and floor of the pool shall be cleanable white or light colored and skid resistance.

Handhold – is required and shall not be more than nine (9) inches above the water line on all sides of the pool.

Decking – Unobstructed deck areas of not less than 48 inches wide shall be provided to extend entirely around the pool. The deck shall be sloped away from the pool to drain at a grade of ¼ inch to 3/8 inch per lineal foot. The deck shall be constructed of materials that are non toxic, impervious, permanent, and enduring. Deck drains must have pipelines at least two (2) inches in diameter; drain opening must be at least four times the cross-sectional area of the drain pipe and shall not be connected to the re-circulation system piping. **Above ground pools are not required to have decking.**

Piping – all piping for pools, spas, and hot tubs shall be constructed in accordance with the Minnesota State Plumbing Code and inspected by the City.

Water Supply – There shall be no physical connection between the water supply line and the pool system. A fill spout shall be at least six (6) inches above the upper rim of the pool. If the make-up water goes through a balancing or surge tank, the point of surcharge shall be at least (6) inches above the rim of the tank. An approved vacuum breaker shall be installed between the sillcock or control valve at the fixture and the hose connection if a plumbing fixture is used to fill the pool. The sillcock must be installed above ground level. No over-the-rim spout will be acceptable unless located under a diving board.

Drainage – main outlets shall be at least 20 feet apart and at least 10 feet from the walls. One drain must be located in the deepest end of the pool and all outlets must be equipped with grating having an area of opening not less than four (4) times the cross-sectional area of the outlet pipe. Gratings cannot be readily removable by bathers. Discharge of water to the sanitary sewer is acceptable, however, the outlet for the pools shall end at least six (6) inches above the connection to the sewer.

*Drainage systems must be constructed and supervised by a licensed plumber. Swimming pools, saps, or hot tub drainage cannot be drained onto or across neighboring properties.

Heaters – pool heaters and boilers shall be listed for this type of use. Mechanical permits and inspections are required.

Electrical – all electrical installations shall conform with the State Electrical Code. No final inspection will be scheduled until the electrical permit has been issued and the inspection has been completed and approved by the Inspector.

Lighting – all lighting effecting an outdoor pool, spa, or hot tub shall be arranged and shaded to reflect light away from neighboring properties.

Chemical Treatment – gaseous chlorinated systems shall not be used as a disinfecting method for pools, spas, or hot tubs.

Setbacks

City Section 12-510 Setbacks

• No portion of a pool, pool deck, or pool appurtenance shall be located in front of the building line. In addition, the following setbacks shall apply.

1. Water Line:

Front Property Line (Landscape Ponds)	20 Feet
Interior side or interior rear property line	10 Feet
Street side or street rear property line	20 Feet

2. Mechanical Equipment:

Front Property Line (Landscape Ponds)	20 Feet
Interior side or interior rear property line	10 Feet
Street side property line	20 Feet

3. Appurtenances other than mechanical equipment of pool decks:

Front Property Line (Landscape Ponds)	20 Feet
Interior side or interior rear property line	5 Feet
Street property line	20 Feet

4. Pool Deck (In Ground Pool):

Any side or rear property line	5 Feet
--------------------------------	--------

5. Pool Deck (Above Ground Pool):

Interior side property line	5 Feet
Street side property line	20 Feet
Rear Property line (attached to residence)	20 Feet
Rear Property line (not attached to residence)	5 Feet

***All pool, spas, and hot tubs shall be operated and maintained in such a manner as to not be a nuisance or dangerous to life or detrimental to health.** (City Code Section 12-511)

***The Chief Building Official has authority to inspect any pool at any reasonable time during the construction and thereafter to determine whether or not the provisions of the code are being met in regards to health, sanitation, operation, and safety.** (City Code Section 12-512)

*** Other Design and Equipment. Any landscape pond, the design and equipment of which incorporate features other than those set forth herein, shall be subject to review and approval by and in conformance with current public health and safety practices.**